

Dr. Salah Dafea    Dr. Moataz Mostafa

## Model Answer

|  |  |                         |   |
|--|--|-------------------------|---|
| Ministry of<br>Higher Education<br><br>Higher Institute of<br>Engineering and<br>Technology at<br>New Damietta | 1 <sup>st</sup> Semester Mid-Term Exam | Academic year 2019-2020 |  |
|  | Engineering Drawing and Projection     | Subject code: BAS015\   |   |
|  | Basic Science Department               | Time: 1.5 hours         |   |
|  | Date: 09/11/2019                       | Total marks: 25 marks   |   |
|  | No. of pages: 1                        | Year: Prep.             |   |

Answer all questions and make reasonable assumptions for any missing data

### Question (1)

(10 marks)

Draw this outline showing clearly the dimensions for 1:1 scale.

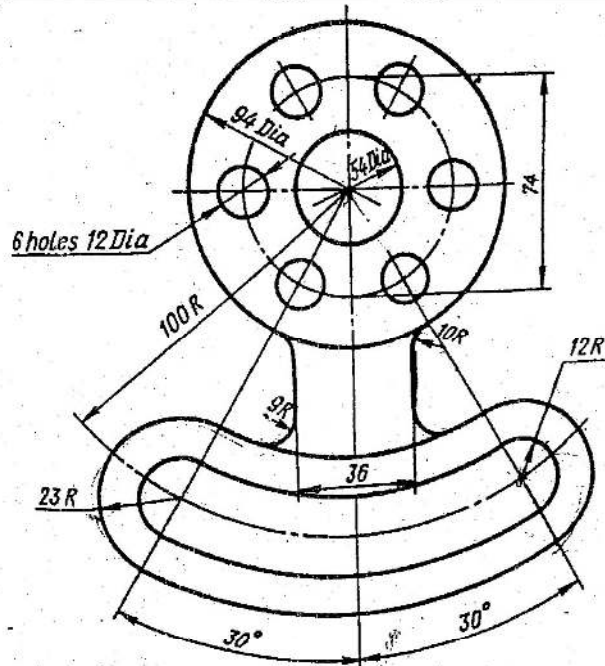
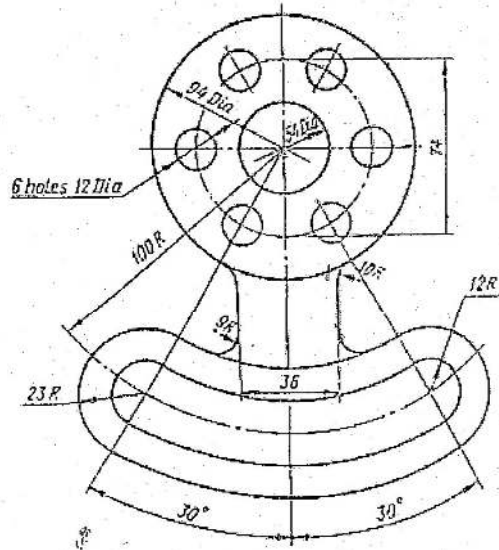

Question (2)

(15 marks)

Draw the three projections (Elevation, Side View and Plan) for the following objects

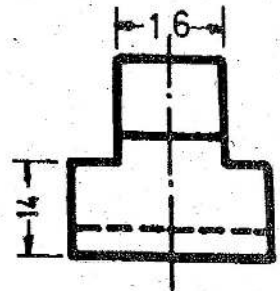
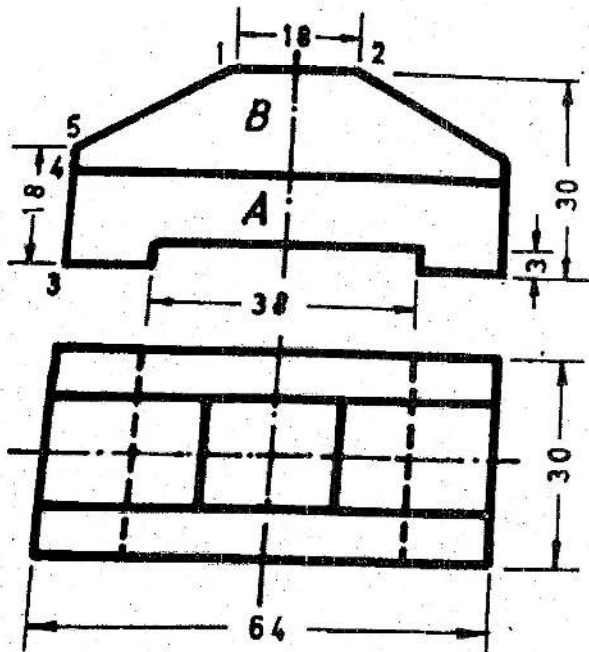

b- Pl.

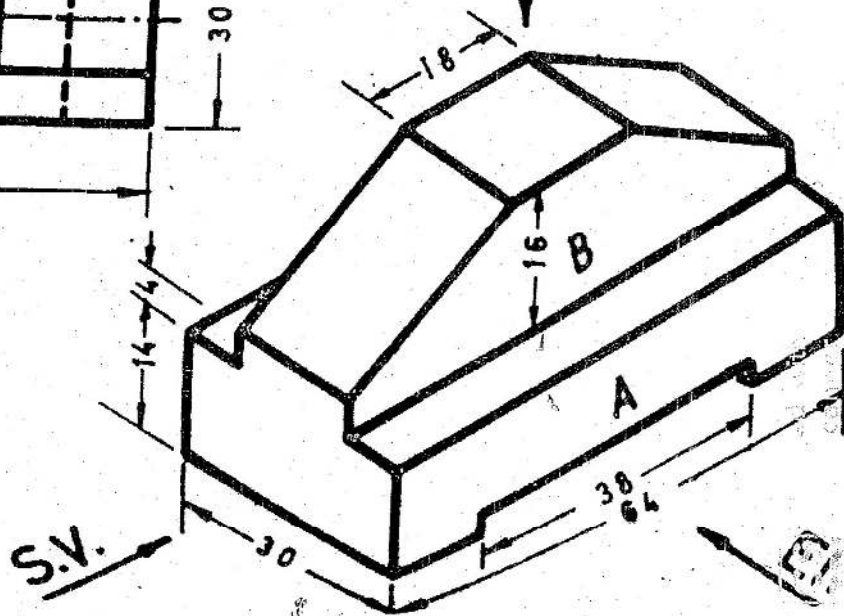

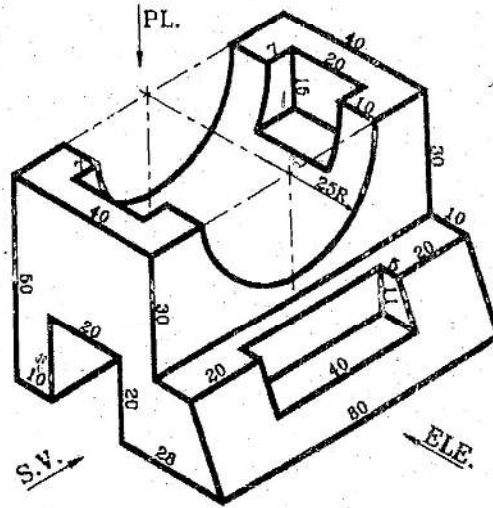
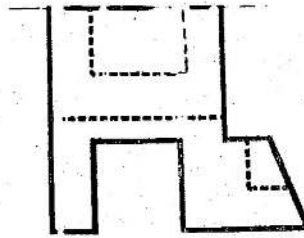

3

## Model Answer

|  |  |                         |   |
|--|--|-------------------------|---|
| Ministry of<br>Higher Education<br><br>Higher Institute of<br>Engineering and<br>Technology at<br>New Damietta | 1 <sup>st</sup> Semester Mid-Term Exam | Academic year 2019-2020 |  |
|  | Engineering Drawing and Projection     | Subject code: ENG 103   |   |
|  | Basic Science Department               | Time: 1.5 hours         |   |
|  | Date: 09/11/2019                       | Total marks: 25 marks   |   |
|  | No. of pages: 1                        | Level: One              |   |

Answer all questions and make reasonable assumptions for any missing data

### Question (1)

(10 marks)

Draw this outline showing clearly the dimensions for 1:1 scale.

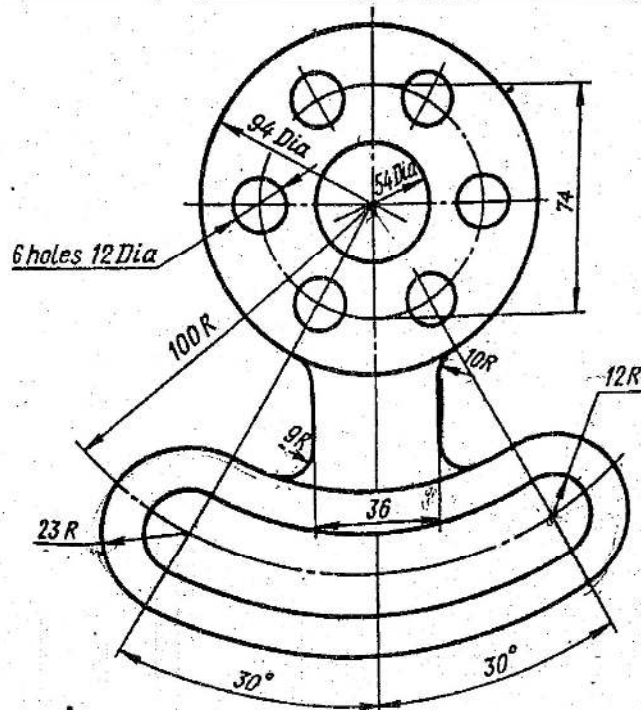
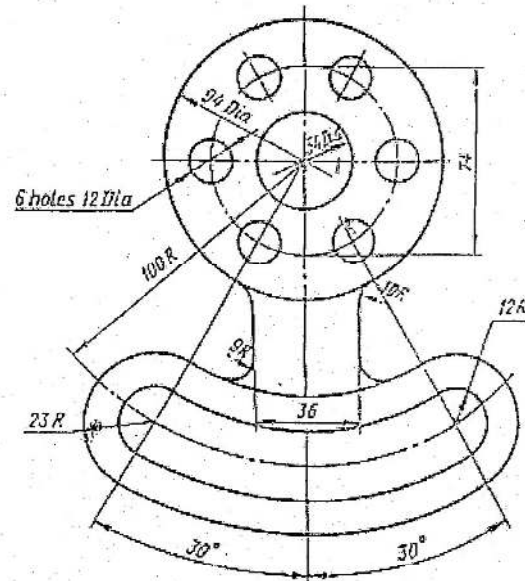

Question (2)

(15 marks)

Draw the three projections (Elevation, Side View and Plan) for the following objects

